

# BOSS PULISCI GRANDI IMPIANTI

Pump for clean-up operations and removal of impurities, suitable for plumbing/hydraulic systems, solar, floor and for large cooling circuits. Suitable for buildings, offices, etc ... tertiary

**COD. 301301011**

## TECHNICAL FEATURES

MOTOR	230 VAC / 50 Hz / 1,1 kW
WEIGHT	60 Kg
ELECTRICAL PROTECTION	IP 44
ATTACKS IN/OUT	1" F
MAX.	90 l/min
OPERATING PRESSURE	5.3 bar
PREVALENCE	53 m
FUEL TANK CAPACITY	40 liters
TEMP.	40°C
SIZE	H: 1070 mm - L: 580 mm - P: 620 mm



## FEATURES PACKAGING PER CARTON

NUMBER OF PIECES PER BOX	1
NUMBER OF PIECES PER EPAL PALLET	2
BOX DIMENSIONS	130x58x50 cm
EPAL PALLET DIMENSIONS	146x80x120 cm
WEIGHT	144 kg
CUSTOMS CODE	8413.82.00
BARCODE	8054633849835

\*Data updated in May 2016

## ADVANTAGES

- Easily transportable
- High performance
- Equipped with electrical panel and safety automation
- Automatic tank filling

## BENEFITS

- Removes sludge from heating circuits
- Reduces bill consumption

## MAIN FEATURES

Impeller pump with a high flow rate and head, by-pass safety valve and appropriate adjustment to the cleaning and loading of large hydraulic plants gender.

Full of pipes and fittings, pressure gauge, non-return valve, anti overflow solenoid valve, three-way valve for recirculation and discharge.

40-liter tank with washable filter with safety float anti flooding and anti-emptying system.

Fully adjustable both in scope, both in prevalence.

Complete with electrical panel, the start-stop button, safety and fuse.

## APPLICATION AND USE

Suitable for remediation of sludge and debris of plants large as well as for the subsequent washing. Suitable for loading and washing of solar and / or thermal plants is of type Conventional and floor. It is also suitable for cooling circuits.

## WHAT DO YOU NEED TO INSTALL

- Hoses for easier connection
- Nipples
- Fittings
- Plumber Typical equipment for various type connections

## CORRECT INSTALLATION

- 1. The pump allows you to:** clean and rinse the recirculated plant chemicals, unclog blockages or obstructions degas the plant, pressurize the system to control the estate
- The relevant functional parts for use are: the pressure regulator valve. The three. The two-way exhaust side to side ball valves supply and exhaust side filling duct and replenishing the tank
- 3. Preparing and connecting**  
Assemble the pipes connecting to the manifolds round system return. Close both exhaust valves and entrance. Fill the clean water tank. Adjust the pressure to a minimum unscrewing the regulator screw. **\*(drawing or photo)** Place the three-way valve on the recirculation
- 4. Goodwill**  
Giving to the pump voltage with the switch slowly open the discharge side valve. Open about 1/2 the exhaust side valve.

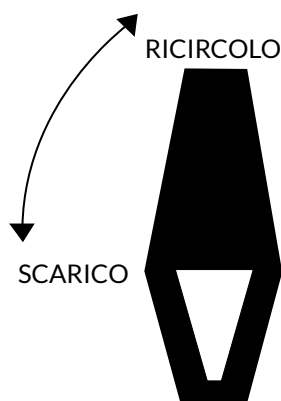

Increase the pressure by tightening the rule tor to the desired pressure.

N.B. The pressure gauge reading is the measured system pressure may presenting two opposite cases:

A - The pressure does not rise

B - The pressure is correct but there is no flow in return. In the first case to act before

What closing the side valve slightly drain, possibly even screw the screw of the regulator. In the second case the plant It is clogged. Fully open side exhaust valve and increase progressive mind the pressure by turning the adjuster screw, the pump can reach up to 10 bar.

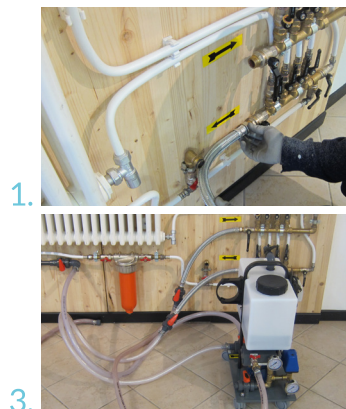

1. Collegamento pompa
2. Dettaglio collegamento tubi (mandata, ritorno)
3. Vista generale pompa correttamente installata (mandata, ritorno, carico e scarico)

### 5. First rinse with clean water

Place the three-way valve in the exhaust and simultaneously adjust the flow alimentation of the reservoir in order to compensate the water leaving the plant. If necessary, close the drain valve if the reinstatement of the tank is insufficient to maintain a stable level. Proceed with rinsing until the water downloaded has not become clear. N.B. Always avoid draining the tank not to introduce into the air.

### 6. Cleaning product with heating

Place the three-way valve of recirculation and placing the product in the tank. to make sure that all the system components are properly cleaned up it is recommended to close all the elements except one. Once you cleaned up the element you can close an open top. After the selective flow, recirculated for 15-20 minutes with all the open elements.

### 7. Drain and final rinse

After the cleaning, proceed as in step 5.

### 8. Product Entry conditioning

Place the three-way valve of recirculation and place the product in the tank. Proceed with a 5-10 minute recirculation.

#### CAUTION:

In case of excessive foaming during use, turn off for a short time the pump and **possibly dilute with water the solution.**

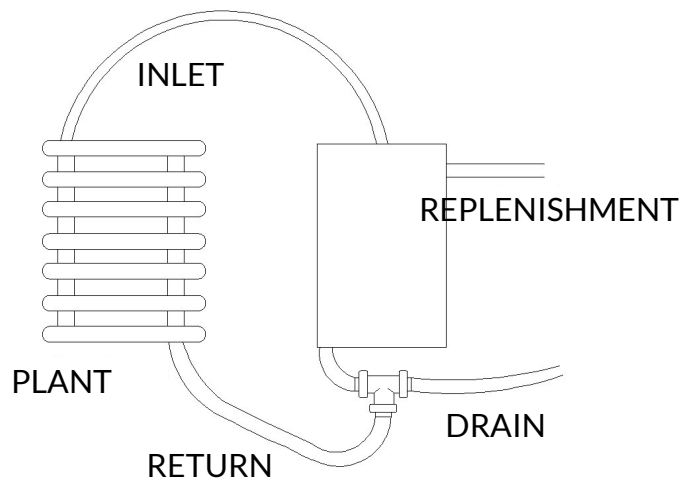

## ADDITIONAL OPERATIONS FOR TESTING THE SYSTEM

### To pressurize the system:

1. Close the ball valve on the distributor block.
2. Connect the ball valve PVC placed under the block to the system through the pipe.
3. Open the valve and turn on the pump.  
After reaching the pressure of 7 bar, the pressure switch automatically shuts off the engine.
4. Check the pressure gauges.
5. Close the valve once the pressure stabilized
6. Remove the equipment.

**Important:** At the entrance of the plant is to be installed a valve and upstream of which there it must be a pressure gauge in order to control any pressure losses.

## EXPLODED VIEW AND SPARE PARTS LIST

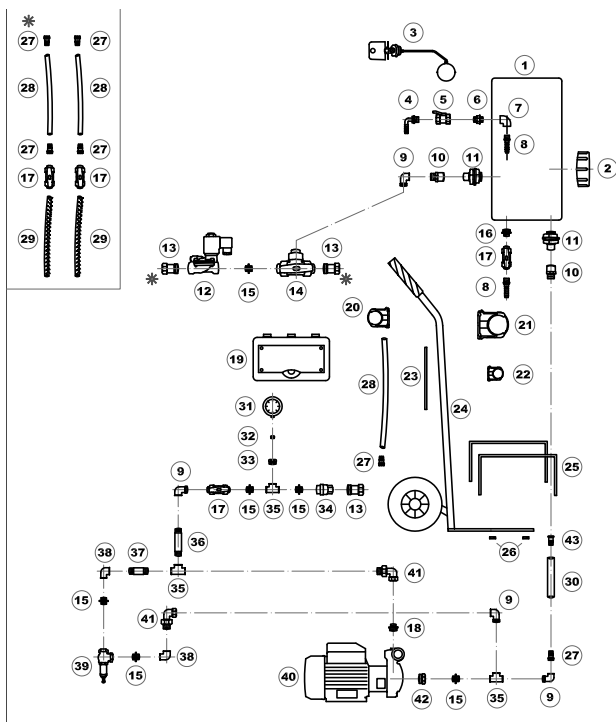

- |                                   |                              |
|-----------------------------------|------------------------------|
| 1- TANK                           | 26- PIPE CARRIER RING        |
| 2- TANK'S CAP                     | 27- ELECTRIC PUMP            |
| 3- OVERFLOW FLOAT                 | 28- M/F 3/4 CONNECTION       |
| 4- SEAL                           | 29- CONNECTION 1" - 3/4"     |
| 5- NIPPLE                         | 30- BRASS NIPPLE             |
| 6- FILLING TAP                    | 31- BIG PVC PLATE            |
| 7- HOSE-FITTING                   | 32- NIPPLE CONNec. 1" - 3/4" |
| 8- PASSWALL                       | 33- "T" BRASS 3/4"           |
| 9- GLUED CONNECTION               | 34- SWITCH                   |
| 10- ANGLE PIPE                    | 35- SMALL PVC PLATE          |
| 11- TWO WAY VALVE                 | 36- FILLIN FLOAT             |
| 12- ELECTROVALVE                  |                              |
| 13- BRASS ANGLE PIPE+PIPE UNION   |                              |
| 14- PRESSURE GAUGE                |                              |
| 15- LONG VALVEE BODY              |                              |
| 16- CART                          |                              |
| 17- ANTI-VIBRATION DAMPERS        |                              |
| 18- BRASS ANGLE PIPE              |                              |
| 19- SHORT VALVE BODY              |                              |
| 20- THREE WAY VALVE               |                              |
| 21- PVC HOSE                      |                              |
| 22- PRESSURE REGULATOR            |                              |
| 23- 3/4 CONNECTION                |                              |
| 24- NETTED HOSE                   |                              |
| 25- FLEXIBLE STAINLESS STEEL HOSE |                              |

## PACKAGING CONTENT

- 1 envelope of fittings
- 1 instruction manual
- 2 stainless steel flexible hoses
- 2 harmored hoses
- 2 2-way valves

## MAINTENANCE

### Important: after use at the end of the day:

1. Carefully wash the pump and filter with recirculated water for at least 10 minutes to remove sludge and the descaling solution. To improve the maintenance you can use a small quantity of BP 100 in recirculation.
  2. Replace the sponge filter in the tank whenever it becomes necessary. Never use a dirty filter for additives or antifreeze loading.
  3. To avoid any corrosion and blockage of the impeller, remove as much water as possible from the pump, the pipes and the tank.
  4. Periodically unscrew the drain nut on the body of the pump and spray an anticorrosive product. Observe the rules for the use and the disposal of the exhausted solution. In case of dripping it is recommended an immediate cleaning with water rinse. Avoid getting the pump motor wet.
- NEVER LEAVE THE PUMP IN FUNCTION. NEVER USE THE PUMP FOR RECIRCULATION OF ACIDIC PRODUCTS.**

## OPTIONAL

---

Pump cleaning adaptor  
cod.301310001



## SIMILAR PRODUCTS

---

Pulisci prova impianti media  
COD. 180400028



## SIMILAR PRODUCTS

---

1. Conditioning Products
2. Geothermal Products
3. Cooling Products

## OFFER DESCRIPTION

---

Twin impeller with high flow rate and hydraulic head, safety by-pass valve and appropriate adjustment to washing and loading of hydraulic installations. Complete of piping and fittings, pressure gauge, no-return valve with electric control, recirculation and drain 3-way valve. 20 litres tank with washable filter equipped with security float for anti-flooding and anti-emptying of the plant. Flow rate and hydraulic head fully adjustable. Complete with electrical panel, Start/Stop push button, safety and fuse holders.

Insulation materials and construction of electrical parts are in compliance with CEI regulations. Insulation degree IP 44.

## COMPLIANCE

---

The product PULISCI GRANDI IMPIANTI is designed and manufactured in compliance with the following European directives (included all the applicable amendments):

Directive 2006/42/EC: Machines

Directive 2014/35/EU: Low Voltage

Directive 2014/30/EU: Electromagnetic Compatibility

Directive 2011/65/EC: RoHS 2

## PRODUCT ORIGIN

---

 Made in Italy

T.D.S. 356.00  
Issue Date: 19/12/2017  
Revision Date:

Boiler Performance by Manta Ecologica S.r.l.

Viale Archimede, 45 - 37059 - Zevio (Vr)

[www.boilerperformance.it](http://www.boilerperformance.it)

