



## BOSS TRANSFORMER PFH 55

Pump designed to restore heating system, with a high head

COD. 301301012

### CHEMICAL AND PHYSICAL FEATURES

TANK	55 l
IN/OUT CONNECTIONS	3/4" F
MAX. FLOW RATE	50 l/min
PRESSURE	4,2 bar
MOTOR	230VAC/ 50 Hz/ 0,75 kW
DEGREE OF PROTECTION	IP 44
WEIGHT	21 kg
MAX. TEMPERATURE	40° C
CONNECTIONS	3/4" F
MATERIAL	PP and aluminum
DIMENSIONS	H: 1020 mm L: 460 mm P: 550 mm

### PACKAGING FEATURES

NUMBER OF PIECES PER BOX	1 pz
NUMBER OF PIECES PER EPAL PALLET	2 pz
BOX DIMENSIONS	H: 115 L: 58 P: 50 cm
EPAL PALLET DIMENSIONS	80x120x130 cm
PRODUCT WEIGHT	21 kg
BOX WEIGHT	23 kg
EPAL WEIGHT	66 kg
CUSTOMS CODE*	8413.81.00
BARCODE EAN 13	8050616510396

\*Data updated in May 2016

## ADVANTAGES

- Easy handling
- High head
- Specific for the cleaning of radiator systems
- Exclusive design
- Incorporated pressure gauge

## BENEFITS

- Optimal heat exchange restoring
- Energy consumption reduction
- Reduction of energy consumption visible on your bill
- Reduction of processing time thanks to the
- Complete hydraulic control system
- Run dry safely

## MAIN FEATURES

Boss Transformer PFH 55 pump has been designed to offer to the final user a solid product, multifunctional and with unique features present on the market. This product guarantees to the maintenance technician to operate both with products suitable for the restoring and conditioning of closed heating and cooling circuits with a very high head. This product has the maximum modularity, also expressed in the shapes, that makes it customizable and extremely versatile.

The supporting structure in varnished aluminum is hooked to a tank in shock resistant, reinforced and antacid polypropylene tank. Electrical pump with centrifugal impeller, threaded recaculating pipes, equipped with closing valves and flexible connections to simplify the connection to the system. 3-ways valve for the fast flows exchange, and PVC, anticorrosive fitting.

The pump is equipped with a tap on the lower part to simplify the drain of the tank and an incorporated pressure gauge for the immediate control of the pressure inside the system.

## APPLICATION AND USE

Pump for the cleaning, refill, restoring and drain of heating and cooling systems, radiators, made of any plastic and metal material.

## WHAT DO I NEED TO INSTALL IT

- Flexible pipes for an easier connection
- Nipples
- Connections
- Typical plumber's tools for connections of different type

## CORRECT INSTALLATION

1. Connect the pipes to the device (discharge, return, charge and drain)
2. Control the connections endurance
3. Connect the pump to the system that has to be treated
4. Fill the tank with clean water and add the restoring/descaling chemical product

## EXPLODED VIEW AND SPARE PARTS

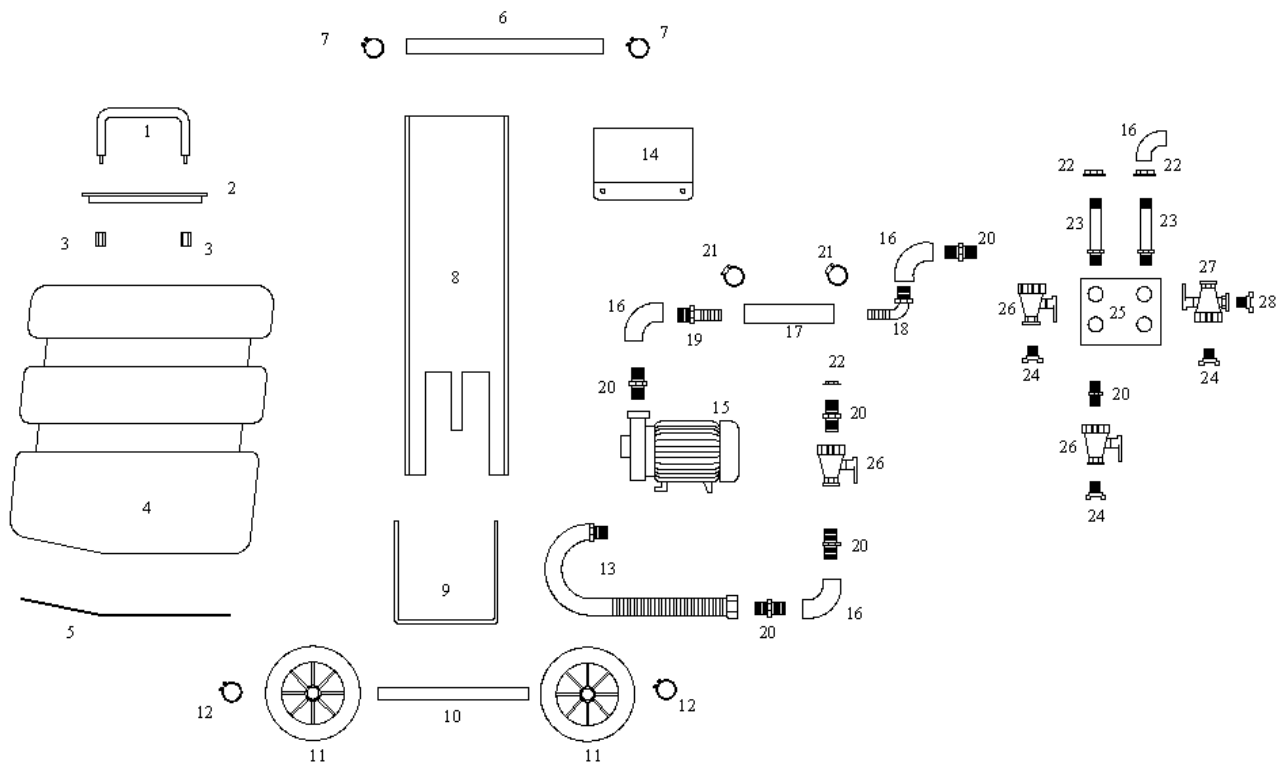

- 1 - HANDLE
- 2 - HANDLE LID
- 3 - PVC HANDLE NUTS
- 4 - TANK
- 5 - LOWER PLATE

- 6 - HANDLE
- 7 - ELASTIC HANDLE RING
- 8 - HANDLE BOX
- 9 - BRACKET WHEELS
- 10 - PIVOT WHEELS

- 11 – WHEELS
- 12 – WHEELS ELASTIC RING
- 13 – INOX FLEXIBLE PIPE
- 14 – HANDLE LID
- 15 – RESTORING ELECTRICAL PUMP
- 16 – ¾" ELBOW
- 17 – PVC BRAIDED PIPE
- 18 – CURVE HOSE HOLDER
- 19 – STRAIGHT HOSE HOLDER
- 20 – ¾" NIPPLE
- 21 – HERBIE HOSE CLAMP
- 22 – THREADED WASHER
- 23 – ¾" EXTENSION CABLE
- 24 – RAPID COUPLING
- 25 – PERFORATED PLATE
- 26 – 2-WAY VALVE
- 27 – 3-WAY VALVE

## PACKAGE CONTENT

---

- Pump
- Connection pipes equipped with connections of ¾" and hose clamps:
  - 2 m discharge wired hose
  - 2 m return wired hose
  - 2 m replenishment wired hose
- User's guide

## MAINTENANCE

---

Respect all regulations for the use and disposal of the finished solution. It is suggested, in case of dripping, the immediate cleaning with water rinse. Be careful not to wet the motor of the pump.

Periodically control the connections holding.

**DO NOT LEAVE THE PUMP UNATTENDED WHILE IT IS IN OPERATION. AT THE END OF DESCALING OPERATIONS, PROCEED TO ABUNDANTLY RINSE THE PUMP WITH CLEAN WATER. DO NOT LEAVE ANY CHEMICAL PRODUCT INSIDE THE TANK.**

## OPTIONAL

1. Pump cleaning adaptor  
COD. 301310001
2. Kit tubi HF  
COD. 301310004



## SIMILAR PRODUCTS

- |   |   |
|---|---|
| <ol style="list-style-type: none"> <li>1. Boss Hyperflush 36<br/>COD. 301301001</li> <li>2. Boss Transformer<br/>Combi HF 75<br/>COD. 301301005</li> <li>3. Boss Transformer<br/>Combi HF110<br/>COD. 301301006</li> <li>4. Boss Transformer<br/>PFH 85<br/>COD. 301301013</li> </ol> | <ol style="list-style-type: none"> <li>5. Boss Pulisci Prova<br/>Impianti Media<br/>COD. 301301010</li> <li>6. Boss Pulisci Grandi<br/>Impianti<br/>COD. 301301011</li> </ol> |
|---|---|



## TO BE USED WITH

1. Conditioning products for heating systems
2. Geothermal products
3. Cooling products
4. Solar thermal products

## OFFER DESCRIPTION

Centrifugal electrical pump for the restoring of small and medium heating systems.  $\frac{3}{4}$ " connections, 55 litres tank. Flow rate 50 l/min, head 4,2 bar. Electricity supply 230 VAC.

## COMPLIANCE

---

This product mod. BOSS TRANSFORMER PFH 55 has been designed and constructed in accordance with the following European directives (including all applicable amendments):

Directive 2006/42/EC: Machine

Directive 2014/35/EU: Low Voltage

Directive 2014/30/EU: Electromagnetic Compatibility

Directive 2011/65/EC: RoHS 2

In addition, declares, that the electrical material used to made the product is in compliance with Regulation CEI-EN 60034: Electrical rotating machines. Part 1: Nominal and operative features

## ORIGIN OF THE PRODUCT

---

 Made in Italy

P.S. 401.00  
Date of issue: 30/10/2017  
Date of revision:

Boiler Performance by Manta Ecologica S.r.l.

Viale Archimede, 45 - 37059 - Zevio (VR)

[www.boilerperformance.com](http://www.boilerperformance.com)

